



1625 PENCIL GRIP WIRE DRIVER

1625
Pencil Grip Wire Driver, cannulated

Accepts K-wires with special plastic guides.
Cannulated to .062" (1.6mm)

Choose an air hose connector to match your power source;
MicroAire®, Hall®, Mini-Driver™ Style, Stryker®, or Synthes®.



Sold as Each / Sterile or Non-Sterile†			
Twist Drills for MicroAire 1625, Wire Driver with Wire Guide			
(Wire Guide required / is not included)			
Diameter	Length	MicroAire #	
1.1mm	49mm	8051-111	
1.5mm	65mm	8051-115	
2.0mm	65mm	8051-120	
2.7mm	79mm	8051-127	
			
Wire Guide for Drills		1600-012NS	
Sold in Packs of 6 – Non-Sterile Only			

† To order non-sterile twist drills, add “**NS**” to the end of the product number. (8051-120**NS**)

K-Wire with Guide

- For use with MicroAire 1625 Pencil Grip Wire Driver

MicroAire K-Wire with Wire Guide							
Sold in 6-packs only			Wire Diameter				
Length	Point Style	Type	0.7mm	0.9mm	1.1mm	1.4mm	1.6mm
			.028"	.035"	.045"	.054"	.062"
5.5"	Double Trocar	Smooth	1600-020	1600-021	1600-022		1600-023
Wire Guide only (non-sterile)			1600-009NS	1600-010NS	1600-011NS	1600-013NS	1600-012NS
	Color		Red	Blue	Yellow	White	Black

Motors

1000-100	Pneumatic motor with throttle (MicroAire® connector)
1000-200	Pneumatic motor with throttle (Hall® connector)
1000-300	Pneumatic motor with throttle (Mini-Driver™ Style connector)
1000-400	Pneumatic motor with throttle (Stryker® connector)
1000-600	Pneumatic motor with throttle (Synthes® connector)
1050-100	Pneumatic motor without throttle (MicroAire® connector)
1050-200	Pneumatic motor without throttle (Hall® connector)
1050-300	Pneumatic motor without throttle (Mini-Driver™ Style connector)
1050-400	Pneumatic motor without throttle (Stryker® connector)
1050-600	Pneumatic motor without throttle (Synthes® connector)

1000ET	Electric motor with throttle
1000E	Electric motor without throttle

1625-100	Pencil Grip wire driver (MicroAire® connector)
1625-200	Pencil Grip wire driver (Hall® connector)
1625-300	Pencil Grip wire driver (Mini-Driver™ Style connector)
1625-400	Pencil Grip wire driver (Stryker® connector)
1625-600	Pencil Grip wire driver (Synthes® connector)

Electric Accessories

1025	Universal Electric Console
1006-1000	Electric handpiece cable for 1000 and 1641 electric instruments for 1025 console
1006-6000	Electric handpiece cable for 2006E, 6640E and 6000 instruments for 1025 console
6401-000	Foot pedal for 1025 console

Pneumatic Accessories

9000-000	10 foot (3 meter) pneumatic hose with MicroAire® connector
9010-000	Throttle locking rings, 10 pack
9013-000	10 foot (3 meter) pneumatic hose with Hall® connector
9014-000	10 foot (3 meter) pneumatic hose with Mini-Driver™ Style Connector
9017-000	10 foot (3 meter) pneumatic hose with Stryker® connector
9100-000	Pneumatic foot control with 10 foot (3 meter) hose
9500-000	Single outlet regulator
9502-000	Dual outlet regulator

Head Modules

1922	Micro Sagittal Saw	1990	Synthes Style Drill
1930	30K RPM Micro Drill	1932	20° Angle Micro Drill
1945	Reciprocating Saw	2130	90K RPM High-Speed Drill
1950	Hall® Style Sagittal Saw, Keyless	1955	Hall® Style Sagittal Saw Wire Driver
1970	Micro-Oscillating Saw	1995	
1972	Oscillating Saw		
1976	Keyless Oscillating Saw		
1980	Jacobs Style Drill		

Other Accessories

1100-005	Long bur guard for 1940, 1930 and 1932 drill
1100-006	Extra-long bur guard for 1940, 1930 and 1932 drill
1140-010	Irrigation clip for 1940, 1930 and 1932 drill
2910-010	Irrigation clip for 1935 drill module
2910-011	Long bur guard for 1935 drill
2910-019	Extra-long bur guard for 1935 drill
1745-001	Locking wrench for 1972 Oscillating Saw
2250-001	Locking key for 1955 Hall® Style Sagittal Saw
2651-000	Sterilization case for 1000 series modular instruments
6651-050	Sterilization case for 5 unitized instruments

Hall® is a registered trademark, and Mini-Driver™ is a trademark of Linvatec Corporation, a subsidiary of ConMed Corporation. Stryker® is a registered trademark of Stryker Corporation. Synthes® is a registered trademark of Synthes (USA). These companies are not affiliated with MicroAire Surgical Instruments LLC.

MicroAire®
SURGICAL INSTRUMENTS

1641 Edlich Drive Charlottesville, VA 22911 U.S.A.
TOLL FREE (800) 722-0822 (434) 975-8000
FAX (800) 648-4309 (434) 975-4131

Visit us online at:
www.microaire.com

©2007, MicroAire Surgical Instruments LLC, LIT-1000E, Rev. G Printed in USA 5/07



A COLSON ASSOCIATE

SERIES 1000

SMALL POWER INSTRUMENTS

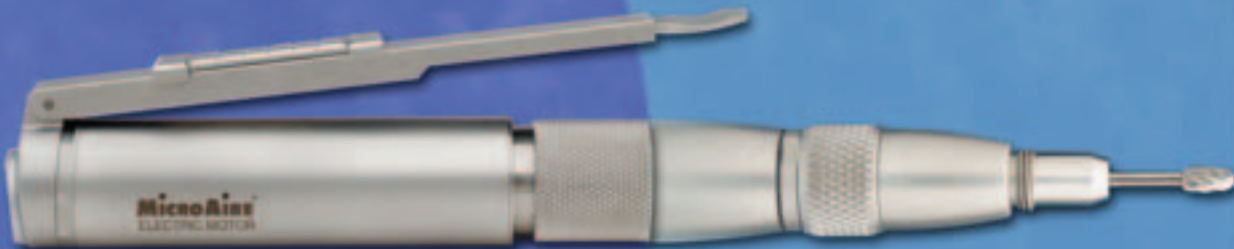

The Most Versatile
Instruments for
Small Bone Surgery

- Electric or Pneumatic
- Modular or Unitized



MicroAire®
SURGICAL INSTRUMENTS

MOTOR MODULES

The MicroAire® Series 1000 Power Instrument System is a small power instrument system that offers versatility and convenience with modular and components.

- The System includes:
- a motor - either pneumatic or electric, with or without hand throttle
 - 13 interchangeable head modules
- A quick connect system that allows you to switch heads during a procedure without disconnecting the hose or cable.

The head modules can be used with either the electric or pneumatic motor, giving you the flexibility of having two systems by changing only the motor. Now you can add instruments to your system just by purchasing an additional head. No need to purchase a motor for each handpiece.

The electric motor is powered by the 1025 Universal Electric Console. With this electric console you set your preferred maximum speed right on the console. This console also has the capability to connect two handpieces at one time.

The Series 1000 is designed to fit your needs. The choice of modules, power source, and control is up to you.



1025 Universal Electric Console



Model 1000-100 Air Motor Module

Also available without hand throttle (1050-100).
(Use with 9100-000 foot pedal)

Choose an air hose connector to match your power source; MicroAire®, Hall®, Mini-Driver™ Style, Stryker®, or Synthes®.

The Series 1000E Electric Modular Instrument System

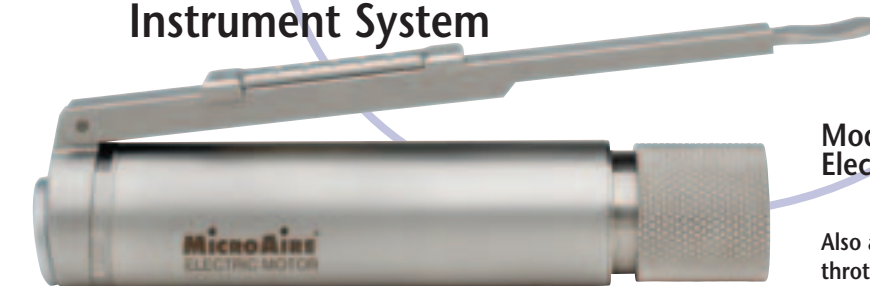

Model 1000ET Electric Motor Module

Also available without hand throttle (1000E).
(Use with 6401-000 foot pedal)

DRILL HEAD MODULES

1930 Micro Drill

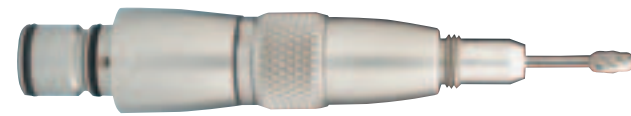

Operating Speed: 30,000 RPM

The work-horse of small bone surgery for sculpting, drilling, passing of wire, and reaming intramedullary canals for small bones. The unit comes standard with a built-in medium length bur guard. Use with any of MicroAire's® extensive selection of ZB series burs. Long and extra-long bur guards are available.

2130 High-Speed Drill



Operating Speed: 90,000 RPM

This well balanced, high performance drill is ideal for neuro, oral, orthopedic as well as plastic and reconstructive surgery. This module gives you high speed for bone sculpting, and power for difficult osteotomies.

1932 20° Angled Drill

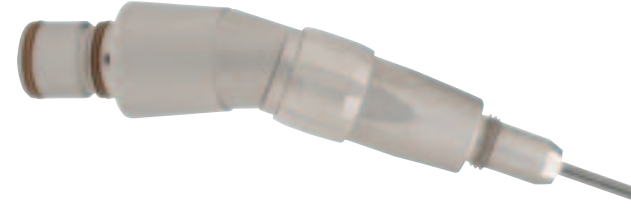

Operating Speed: 30,000 RPM

The 20° angled drill head with twist locking mechanism is particularly useful for precision bone sculpting, cutting, and drilling procedures in orthopedics, oral/maxillofacial, podiatric, and plastic and reconstructive surgery. Will accept long and extra-long burs for hard to reach areas.

1980 Jacobs Style Drill



Operating Speed: 1,670 RPM

Now, you can use Jacobs style twist drills without changing to a wire driver. Simply attach the Jacobs style drill module to your motor module. Use MicroAire® 8051 and 8054 series twist drills with diameters between 1.0mm and 4.0mm, up to 127mm in length.

1990 Synthes Style Drill



Operating Speed: 1,670 RPM

Attach the Synthes style drill module to your motor module. Use any MicroAire® 8053 series quick-coupling twist drills with diameter between 1.1mm and 3.5mm, up to 127mm in length.

1995 Wire Driver



Operating Speed: 1,400 RPM

Automatic grip mechanism securely holds the wire while being driven, and automatically advances wire by simply pulling back on the instrument. Grip mechanism can be locked into position for wire removal. Drives non-threaded K-Wires with guide from .028 to .062 in diameter.

SAW HEAD MODULES

1922 Micro Sagittal Saw

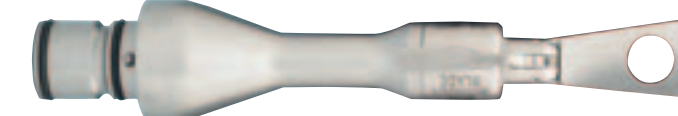

Operating Speed: 30,000 CPM

The sagittal saw module offers the ultimate in control, power and maneuverability for cutting your transverse or wedge osteotomies. Offered with a variety of ultra-thin (.010) straight, angled, bent or offset blades.

1950 Keyless Hall Style Sagittal Saw

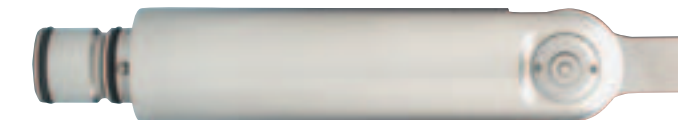

Operating Speed: 18,000 CPM

Very powerful, designed to drive the longer, larger sagittal saw blades. Features a simple push button release design, no hex wrench needed for locking blades. Blades can be positioned at any point along 160° arc providing good visibility and optimal approach. Particularly useful in transverse or wedge osteotomies.

1955 Hall Style Sagittal Saw



Operating Speed: 18,000 CPM

Very powerful, designed to drive the longer, larger sagittal saw blades. Blades can be positioned at any point along 160° arc, providing good visibility and optimal approach. Particularly useful in transverse or wedge osteotomies.

1970 Micro-Oscillating Saw



Operating Speed: 24,000 CPM

Use this module for precise curved and straight osteotomies.

1972 Oscillating Saw



Operating Speed: 24,000 CPM

The 1972 oscillating saw was specially designed for foot surgery. A wide selection of straight, bent, and crescentic cutting blades is available for this special purpose head module. Blades are secured in place by using the included 1745-001 Locking Tool.

1976 Keyless Oscillating Saw



Operating Speed: 18,000 CPM

The 1976 oscillating saw was specially designed for foot surgery. A wide selection of straight, bent, and crescentic cutting blades is available for this special purpose head module.

1945 Reciprocating Saw



Operating Speed: 16,000 CPM

This powerful, quick-cutting reciprocating saw is the instrument of choice for oral and maxillofacial surgery. There is a variety of specially designed thin blades available as well as a variety of rasps for shaping, contouring and preparing intramedullary canals of small bones.